



# **12. Structural engineering studies**

SOIL PROFILE - CAMDEN GOODS YARD

THE RECOMMENDATIONS BELOW ARE BASED ON PRELIMINARY SOIL INVESTIGATIONS. ONCE A SCHEME IS CONFIRMED, FURTHER INVESTIGATION WILL BE REQUIRED.

ANY EXCAVATIONS SHOULD CONSIDER DEWATERING.



NOTES:

- POSSIBLE HIGH VOLUME CHANGE POTENTIAL. SUSPENDED SLAB & FOUNDATION HEAVE PROTECTION REQUIRED.
- SOIL TESTING SHOWED AN ELEVATED SULPHATE LEVEL. CONCRETE WILL NEED TO BE DESIGNED TO MEET DS-3 & AC-3 CLASSIFICATION
- SOAKAWAYS WERE NOT FOUND TO BE SUITABLE IN THIS SOIL. RAINWATER HARVESTING / POREOUS PAVING / AQUACELLS ARE ALTERNATIVES
- BASED ON THE READINGS TO DATE, GAS PROTECTION MEASURES WOULD BE REQUIRED FOR THIS SITE. FURTHER MONITORING IS RECOMMENDED.
- WASTE CONTAINING ASBESTOS WAS FOUND ON SITE. THIS WOULD NEED TO BE TREAT ON-SITE OR SENT TO A SPECIALIST LANDFILL.

MAX DEPTH 15m BGL - BOREHOLE

RISK: NO INVESTIGATION WAS CARRIED OUT FOR THE GILBEYS YARD PLOT. THEREFORE THE SOIL PROFILE IS UNCERTAIN. DUE TO THE VARIABILITY IN THE LAND, THE SOIL COULD BE CONSIDERABLY DIFFERENT TO JUMPER CRESCENT.







N

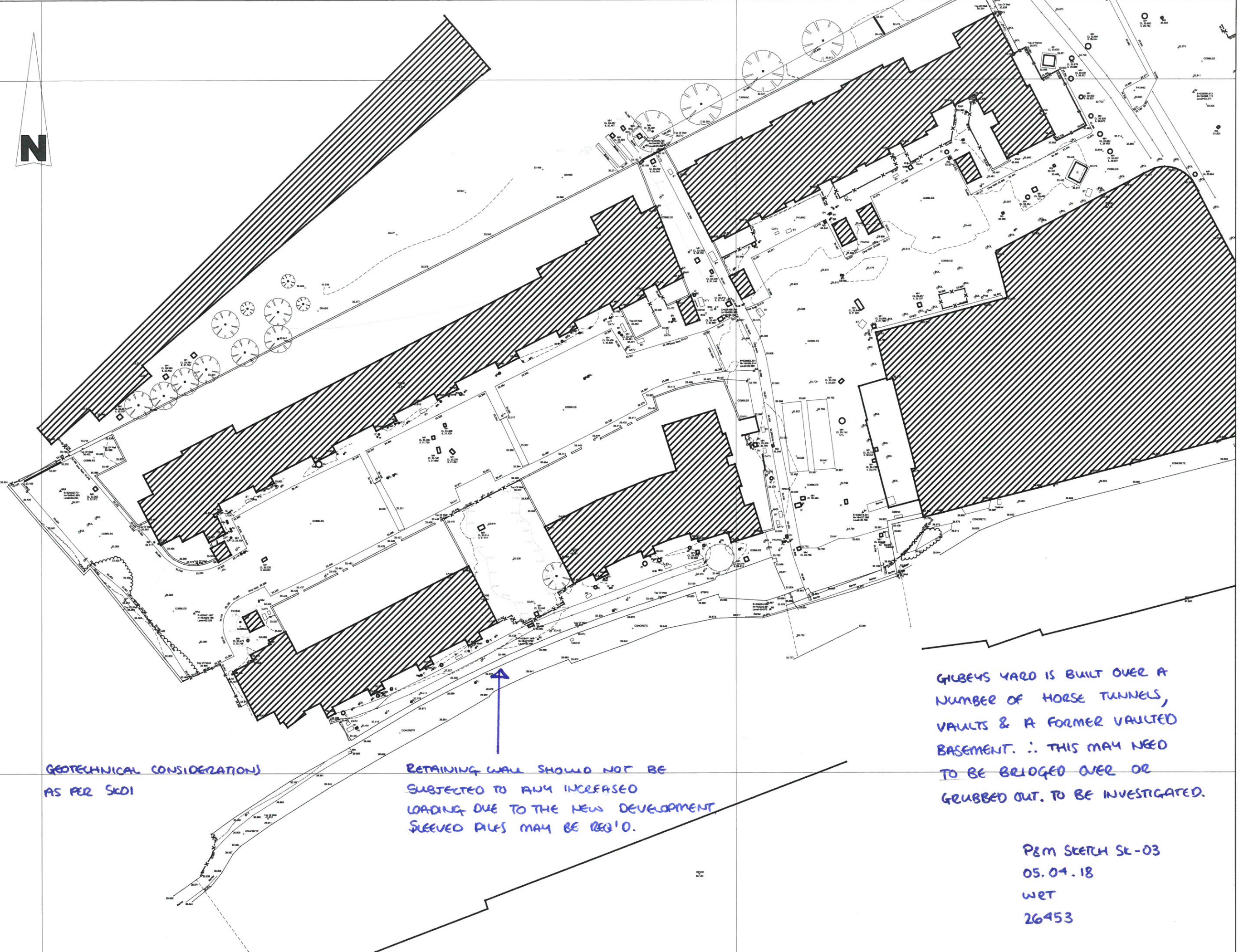

**KEY**

CONCRETE	CONCRETE BASE
ASPHALT	PAVING
GRAVEL	GRAVEL
BRICK	BRICK
SLATE	SLATE
ROOF	ROOF
RAILING	RAILING
...	...

**UTILITY KEY**

1" BELOW GROUND	WATER MAIN
2" BELOW GROUND	WATER MAIN
3" BELOW GROUND	WATER MAIN
4" BELOW GROUND	WATER MAIN
5" BELOW GROUND	WATER MAIN
6" BELOW GROUND	WATER MAIN
7" BELOW GROUND	WATER MAIN
8" BELOW GROUND	WATER MAIN
9" BELOW GROUND	WATER MAIN
10" BELOW GROUND	WATER MAIN
...	...

**ABBREVIATIONS**

AC	ANNULUS CONNECTION	MT	METROPOST
AD	ANNULUS DRAIN	MP	METROPOST
AE	ANNULUS ENTRY	LP	LAMP POST
AF	ANNULUS FLOOR	LP	LAMP POST
AG	ANNULUS GROUND	LP	LAMP POST
...	...	...	...

**NOTES**

1. The information on this drawing is based on the information provided by the client and is not to be used for any other purpose without the written consent of the client.

2. The information on this drawing is not to be used for any other purpose without the written consent of the client.

3. The information on this drawing is not to be used for any other purpose without the written consent of the client.

GEOTECHNICAL CONSIDERATION)  
AS PER SKD1

RETAINING WALL SHOULD NOT BE  
SUBJECTED TO ANY INCREASED  
LOADING DUE TO THE NEW DEVELOPMENT  
SLEEVED PILLS MAY BE REQ'D.

GILBEYS YARD IS BUILT OVER A  
NUMBER OF HORSE TUNNELS,  
VAULTS & A FORMER VAULTED  
BASEMENT. ∴ THIS MAY NEED  
TO BE BRIDGED OVER OR  
GRUBBED OUT. TO BE INVESTIGATED.

P&M SKETCH SL-03  
05.04.18  
WET  
26453

SCALE	DATE	BY
1:250 @ A1	11.10.17	NSC/NRP
1:250 @ A1	05.04.18	WET

SiteScan  
Information to build on

ONE HOUSING			
GILBEYS YARD CAMDEN GOODS YARD CAMDEN			
TOPOGRAPHICAL SURVEY			
SCALE	DATE	BY	BY
1:250 @ A1	11.10.17	NSC/NRP	OS
1:250 @ A1	05.04.18	WET	NG
P17162	1/2	1/2	A